

SHEET 50

REVISIONS

DATE	BY	LIC NO	BLOCK	LOT
08/11/08	ARNOLD W. BARNETT	14987	10	6.01
06/18/09	MATTHEW ZIOLKOWSKI	4223800	8	4.01
06/18/09	MATTHEW ZIOLKOWSKI	4223800	10	7.03
06/18/09	MATTHEW ZIOLKOWSKI	4223800	10	6.01
12/2012	MATTHEW ZIOLKOWSKI	4223800	8	4.01

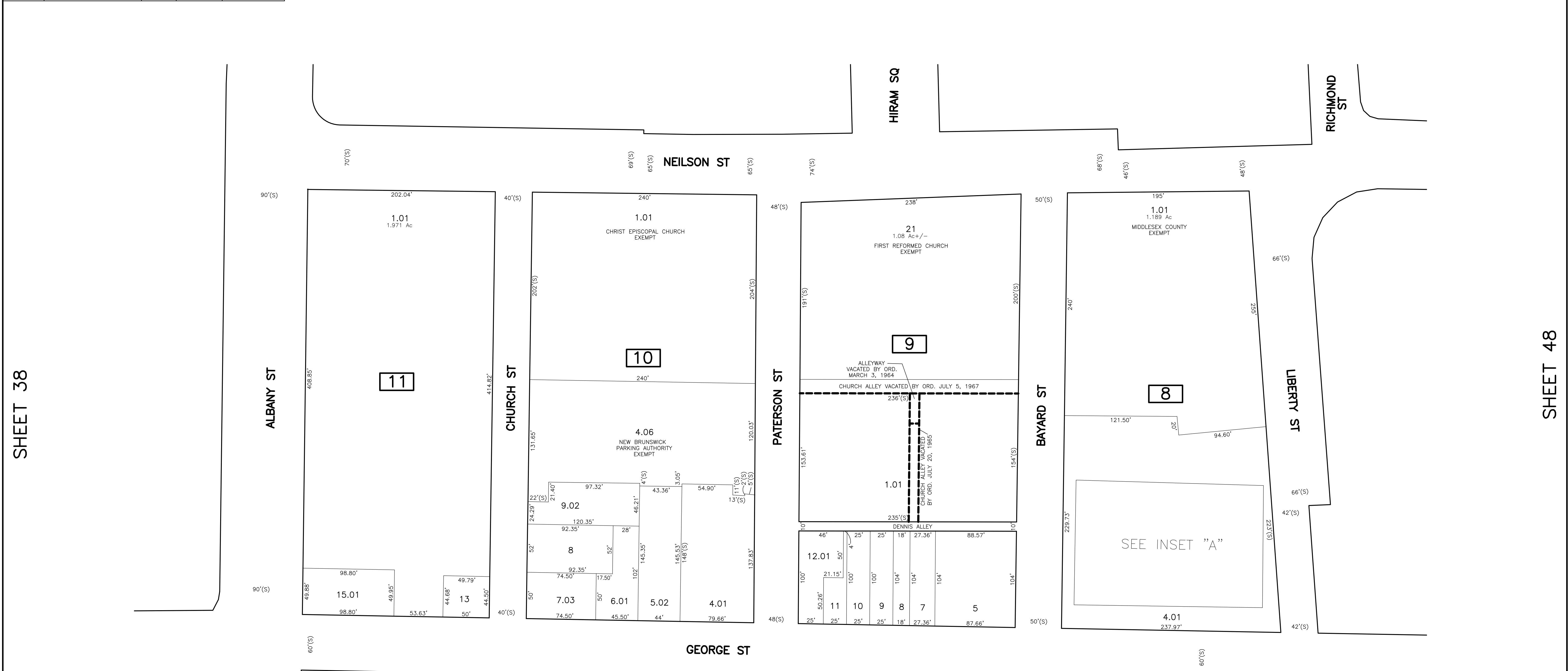
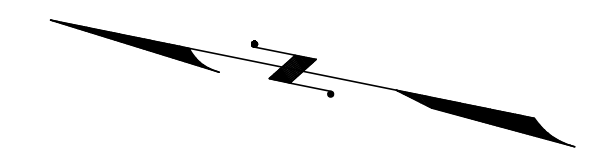

SHEET 38

SHEET 48

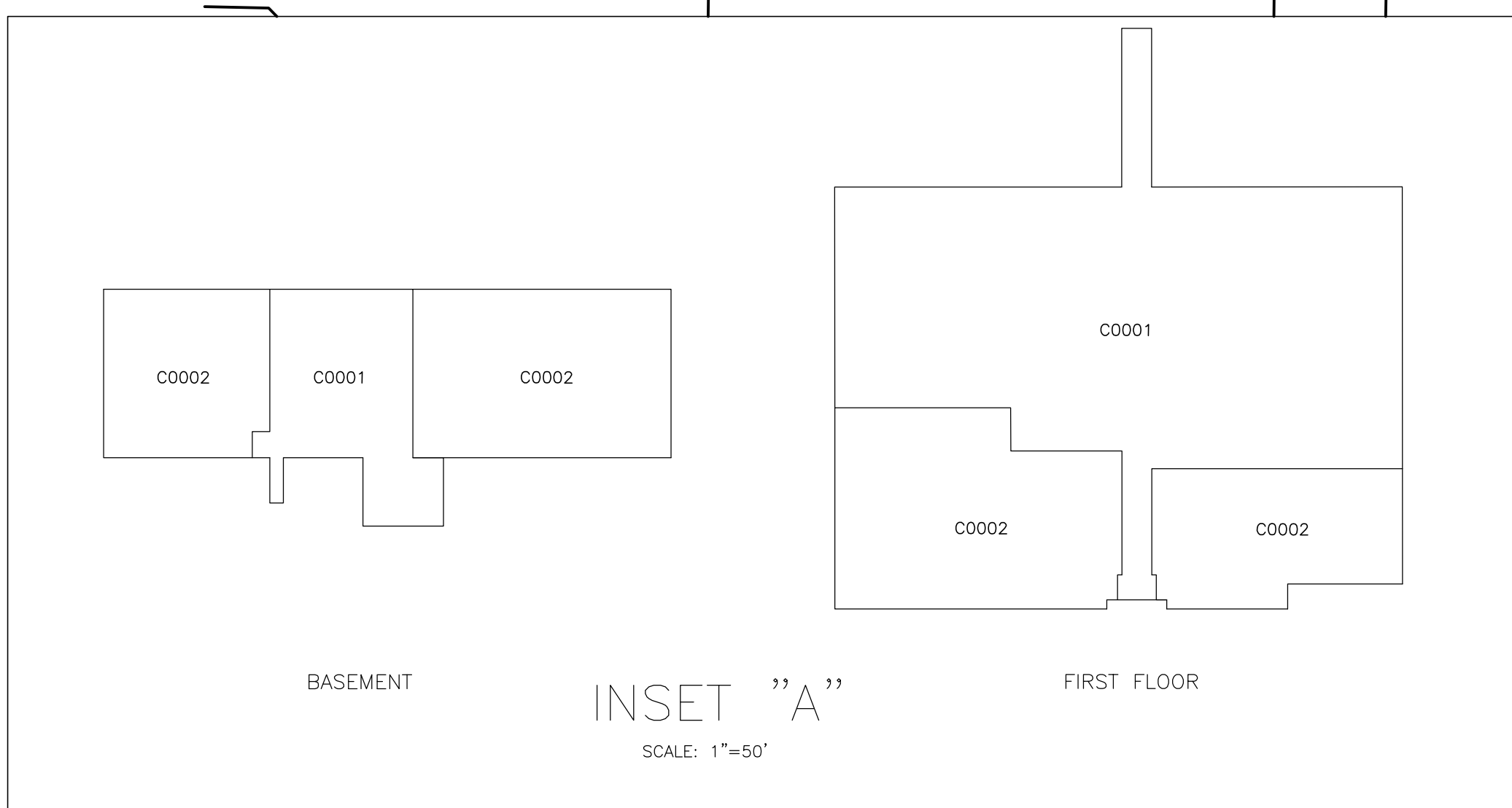

INSET "A"
SCALE: 1"=50'

LIBERTY PLAZA
BLOCK 8 - LOT 4.01

QUAL.	SQ. FT. (TOTAL)
C0001	115,764
C0002	20,834

SHEET 36

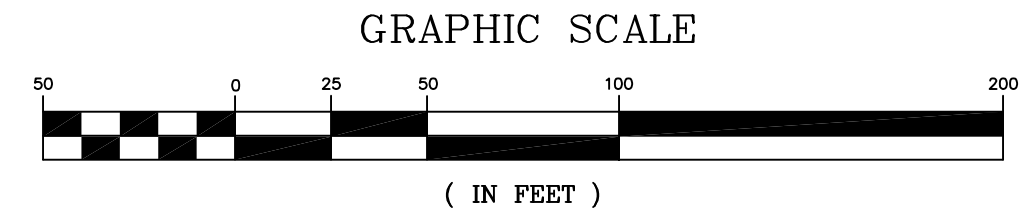

GRAPHIC SCALE
(IN FEET)

NEW JERSEY DEPARTMENT OF THE TREASURY
DIVISION OF TAXATION
PROPERTY ADMINISTRATION
APPROVED AS A PER MAP PURSUANT TO THE AUTHORITY OF
N.J.A.C. 17:27-15 & 16.62-1
FOR THE DIRECTOR, DIVISION OF TAXATION
Thomas S. Reilly, P.E., C.S.
Santo C. DiDonato, P.E., C.S.
DATE: FEB 10, 2009 SERIAL No. 934

SHEET 35

* THIS SHEET HAS BEEN DRAWN USING COMPUTER AIDED DRAFTING/
DESIGN (CAD/D) AND COORDINATE GEOMETRY (COGO).

TAX MAP
CITY OF NEW BRUNSWICK
MIDDLESEX COUNTY
SCALE: 1" = 50'

NEW JERSEY
DATE: JUNE 2007

ARNOLD W. BARNETT
PROFESSIONAL ENGINEER AND LAND SURVEYOR
NEW JERSEY LICENSE NO. 14987

850 SO. WHITE HORSE PIKE
HAMMONTON, NEW JERSEY 08037
COA# 24GA27973300