

SHEET 5

REVISIONS				
DATE	BY	LIC NO	BLOCK	LOT
08/11/08	ARNOLD W. BARNETT	14987	57	52-53
05/15/13	RICHARD A. SCHULZ	37607	57	43, 54
05/15/13	RICHARD A. SCHULZ	37607	58	45

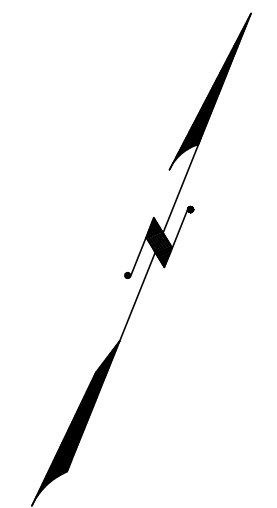

SHEET 10

SHEET 12

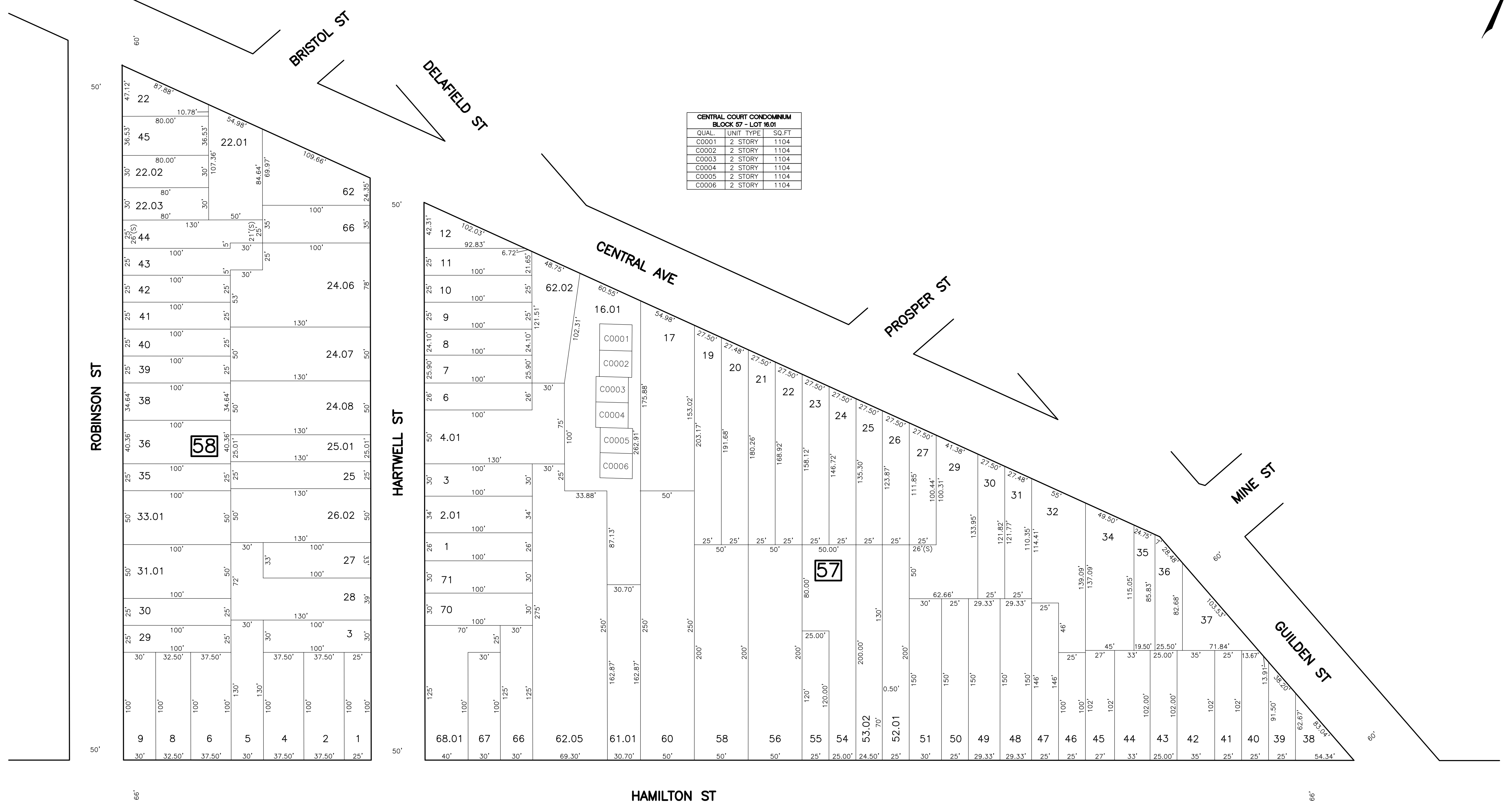

CENTRAL COURT CONDOMINIUM BLOCK 57 - LOT 1601		
QUAL	UNIT TYPE	SQ.FT
C0001	2 STORY	1104
C0002	2 STORY	1104
C0003	2 STORY	1104
C0004	2 STORY	1104
C0005	2 STORY	1104
C0006	2 STORY	1104

SHEET 17

SHEET 18

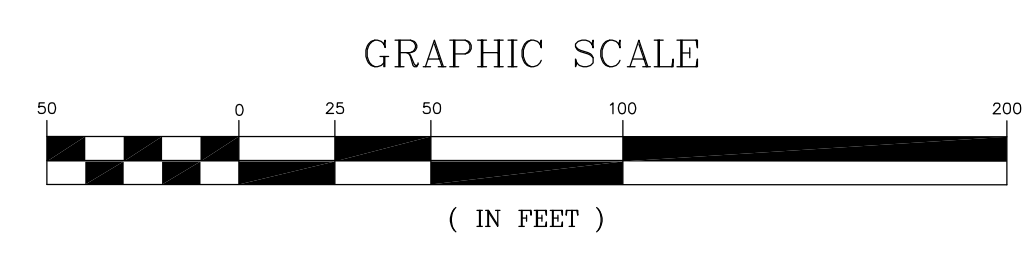

* THIS SHEET HAS BEEN DRAWN USING COMPUTER AIDED DRAFTING/
DESIGN (CAD/D) AND COORDINATE GEOMETRY (COGO).

NEW JERSEY DEPARTMENT OF THE TREASURY
DIVISION OF TAXATION
PROPERTY ADMINISTRATION
APPROVED AS A PLAN PURSUANT TO THE AUTHORITY OF
N.J.A.C. 17:27-15 & 17:27-16
FOR THE DIRECTOR, DIVISION OF TAXATION
Thomas S. Reilly, C.S.
THOMAS S. REILLY, CHIEF, LOCAL PROPERTY FIELD ASSISTANCE
Santo C. DiDonato, C.S.
SANTO C. DIDONATO, SUPERVISING FIELD REPRESENTATIVE
DATE: FEB 10, 2009 SERIAL NO.: 934

TAX MAP
CITY OF NEW BRUNSWICK
MIDDLESEX COUNTY
SCALE: 1" = 50'
NEW JERSEY
DATE: JUNE 2007
ARNOLD W. BARNETT
PROFESSIONAL ENGINEER AND LAND SURVEYOR
NEW JERSEY LICENSE NO. 14987
850 SO. WHITE HORSE PIKE
HAMMONTON, NEW JERSEY 08037
COA# 24GA27973300