

SHEET 73

REVISIONS

DATE	BY	LIC NO	BLOCK	LOT
05/16/13	RICHARD A. SCHULZ	37607	89	21
05/16/13	RICHARD A. SCHULZ	37607	90	21, 23

SHEET 73

SHEET 2

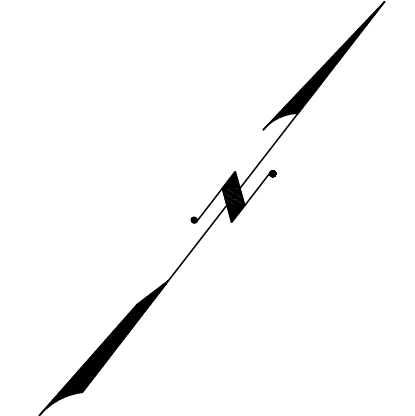
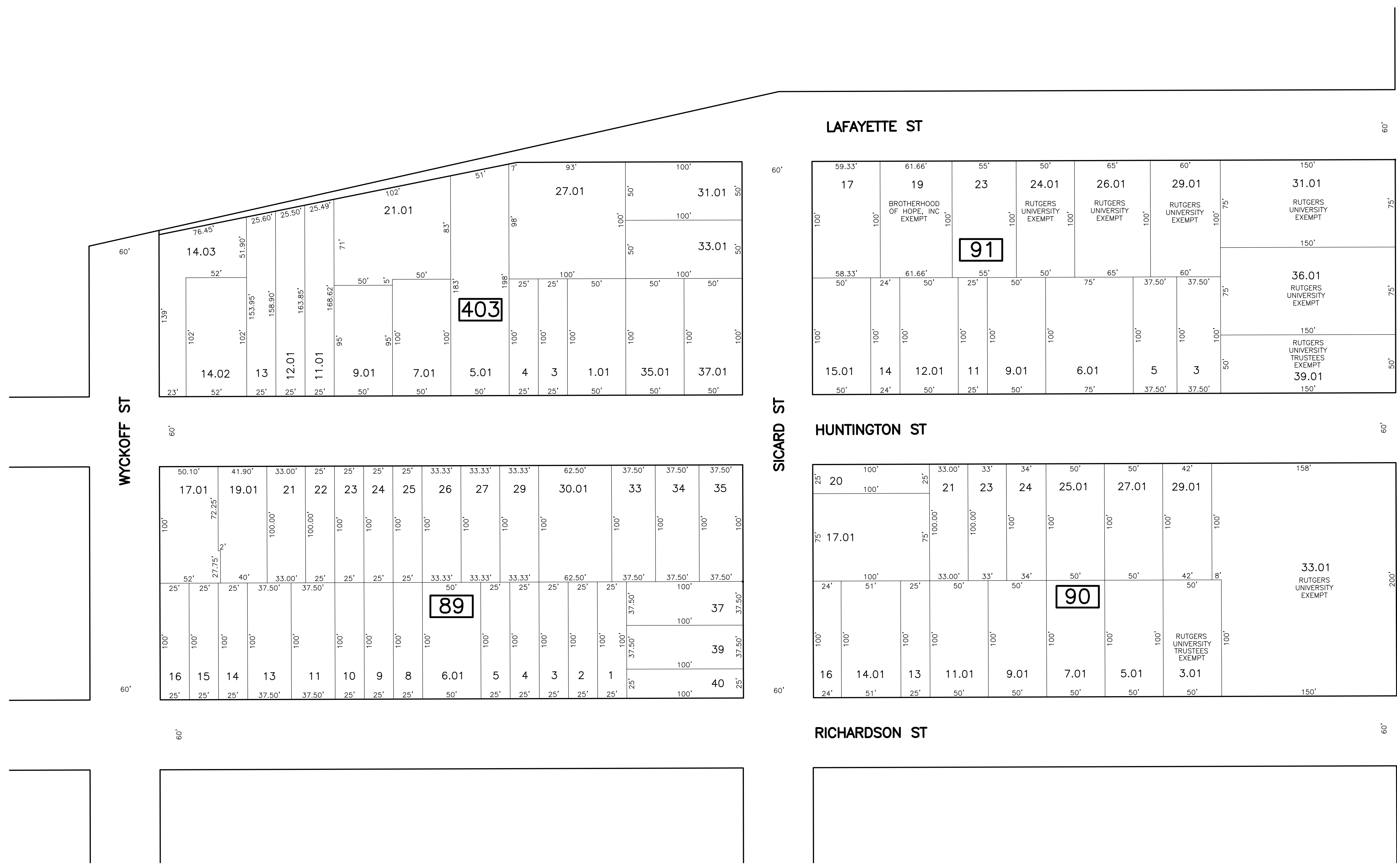

SHEET 4

\* THIS SHEET HAS BEEN DRAWN USING COMPUTER AIDED DRAFTING/ DESIGN (CAD/D) AND COORDINATE GEOMETRY (COGO).

**TAX MAP**  
**CITY OF NEW BRUNSWICK**

MIDDLESEX COUNTY NEW JERSEY  
 SCALE: 1" = 50' DATE: JUNE 2007

**ARNOLD W. BARNETT**  
 PROFESSIONAL ENGINEER AND LAND SURVEYOR  
 NEW JERSEY LICENSE NO. 14987

850 SO. WHITE HORSE PIKE  
 HAMMONTON, NEW JERSEY 08037  
 COA# 24GA27973300

NEW JERSEY DEPARTMENT OF THE TREASURY  
 DIVISION OF TAXATION  
 PROPERTY ADMINISTRATION  
 APPROVED AS A FEE MAP PURSUANT TO THE AUTHORITY OF  
 N.J.A.C. 17:27-15 & 17:27-16  
 FOR THE DIRECTOR, DIVISION OF TAXATION  
 Thomas S. Reilly, C.T.A.  
 THOMAS S. REILLY, CHIEF, LOCAL PROPERTY FIELD ASSISTANCE  
 Santo C. DiDonato, SUPERVISING FIELD REPRESENTATIVE  
 DATE: FEB 10, 2009 SERIAL NO.: 934

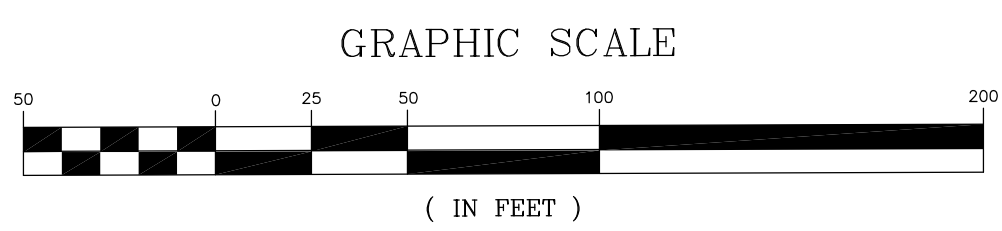

SHEET 6